

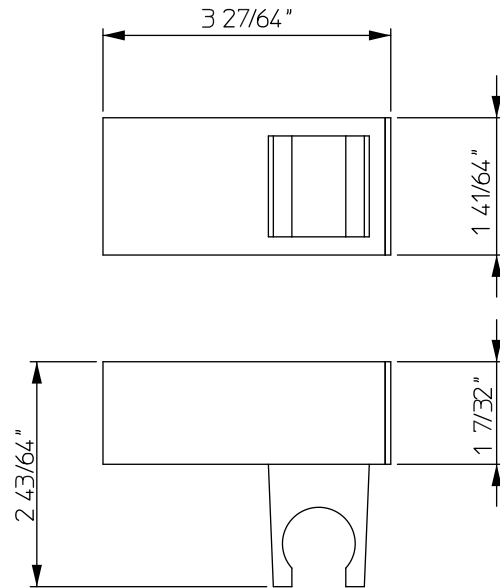

# PALAZZANI showers



code **991026-10**

## Features

- Swivel bracket in abs 3 27/64" x 1 41/64".

## Material

- Abs.
- Finishes resist corrosion and tarnish.

## Certifications

- ASME A112.18.1/CSA B125.1-12.
- California Energy Commission (CEC).
- ADA.

## Available color finishes

- 10 chrome.

## Technical information

- All product dimensions are nominal.
- Wall-mount.

## Warranty

- Limited warranty.
- See website for detailed warranty information.

## Note

- Install this product according to the installation guide.
- Final measurements confirm with product.
- Palazzani reserves the right to make revisions without notice to product specifications.



**PALAZZANI USA**

phone (305) 651.4470 ■ service@palazzaniusa.com